



Safety and cleaning instructions for the LIINI® baby cradle

Dear Customer,

Thank you for choosing our baby cradle. We attach great importance to your safety and the well-being of your family.

To ensure that you can rock your baby safely, it is important to carefully follow the safety instructions below.
Improper use can pose serious risks!

Manual / Operating instructions

We deliberately do not provide printed operating instructions, thereby saving several tonnes of paper every year. At the same time, we can update our electronic operating instructions at any time so that you always have the latest version to hand.

Even though many functions can be operated intuitively, please take **five minutes to read through the instructions**. It is important to use the product in accordance with the operating instructions so that you can enjoy it for a long time, everything works safely and unnecessary annoyance is avoided.

You can find the **operating instructions** via the following **QR code** (scan with your smartphone):



Available online: DE / EN / FR / IT

Bankverbindung CHF:
IBAN: CH06 0021 0210 1087 0101 V
BIC / SWIFT: UBSWCHZH80A

Bankverbindung EUR:
IBAN: CH23 0021 0210 1087 0160 X
BIC / SWIFT: UBSWCHZH80A

Kontakt
LIINI GmbH
Bahnhofstrasse 21
4571 Lüterkofen
Web: www.LIINI.ch
E-Mail: info@LIINI.ch
Tel: +41 79 559 06 02

Rechtliches
UID: CHE-131.522.878 MWST
Steuernr. DE: 09417/18455
Umsatzsteuer-ID: DE352084049
EORI-Nr: DE905090565529397
Zollkonto ZAZ: 19867-7



#Feels Parenting.

General information

Manufacturer	LIINI GmbH Bahnhofstrasse 21 4571 Lüterkofen Switzerland
Contact	compliance@liini.ch
Country of origin	China (CN)
Certifications	DIN EN 1466:2023
EU authorised representative	ProductIP AR Services Galvanistraat 1 6716 AE Ede The Netherlands (authorities only)
WEEE registration number (DE)	74241330 WEEE Register Nordostpark 72 90411 Nuremberg
WEEE registration number (AT)	9008392342860 Federal Ministry for Climate Protection, Environment, Energy, Mobility, Innovation and Technology (BMK) Radetzkystraße 2 1030 Vienna
WEEE registration number (LU)	MA1403 ecotrel asbl 11, Boulevard du Jazz 4370 Belvaux,
WEEE registration number (NL)	42125 Stitching OPEN Baron de Coubertinlaan 7 2719 EN Zoetermeer

Bankverbindung CHF:
IBAN: CH06 0021 0210 1087 0101 V
BIC / SWIFT: UBSWCHZH80A

Bankverbindung EUR:
IBAN: CH23 0021 0210 1087 0160 X
BIC / SWIFT: UBSWCHZH80A

Kontakt
LIINI GmbH
Bahnhofstrasse 21
4571 Lüterkofen
Web: www.LIINI.ch
E-Mail: info@LIINI.ch
Tel: +41 79 559 06 02

Rechtliches
UID: CHE-131.522.878 MWST
Steuernr. DE: 09417/18455
Umsatzsteuer-ID: DE352084049
EORI-Nr: DE905090565529397
Zollkonto ZAZ: 19867-7



General safety instructions (GPSR)

Improper or incorrect assembly of the baby cradle can lead to serious accidents and injuries and poses **serious safety risks**.

Please observe the following instructions carefully:

WARNING – Risk of suffocation and death (SIDS)

- **Always** place your baby **on their back** to sleep to minimise the risk of sudden infant death syndrome (SIDS).
- **Do not** use **additional pillows, blankets, soft toys or padding** in the cradle. These increase the risk of **suffocation or overheating**.
- **Only** use **the mattress supplied**.

WARNING – Risk of falling and injury

- **Never** place the cradle **on tables, beds or other furniture** to prevent falls.
- **Only** place the cradle on a **stable, level and non-slip surface**.

WARNING – Use only within the limits

- **Only** use the cradle **for newborns and babies** who cannot yet **sit up, roll over or push** themselves **up on their hands and knees** without assistance.
- Observe the **maximum weight limit** (e.g. **9 kg**) and stop using the cradle as soon as your baby reaches this limit or becomes **more mobile**.

CAUTION – Environment & location

- **Do not** place the cradle **near windows, curtains, cables** or other potential hazards.
- Keep the cradle **away from heat sources** (e.g. heaters, fireplaces) and **direct sunlight**.

NOTE – Assembly & regular checks

- Regularly check that the cradle is **securely assembled** and **tighten any loose screws**.
- **Never** leave your baby **unattended** in the cradle when they are **awake or restless**.



#Feels Parenting.

Assembly instructions

You should allow approximately 20 to 30 minutes to assemble the LIINI® baby cradle.

Scope of delivery

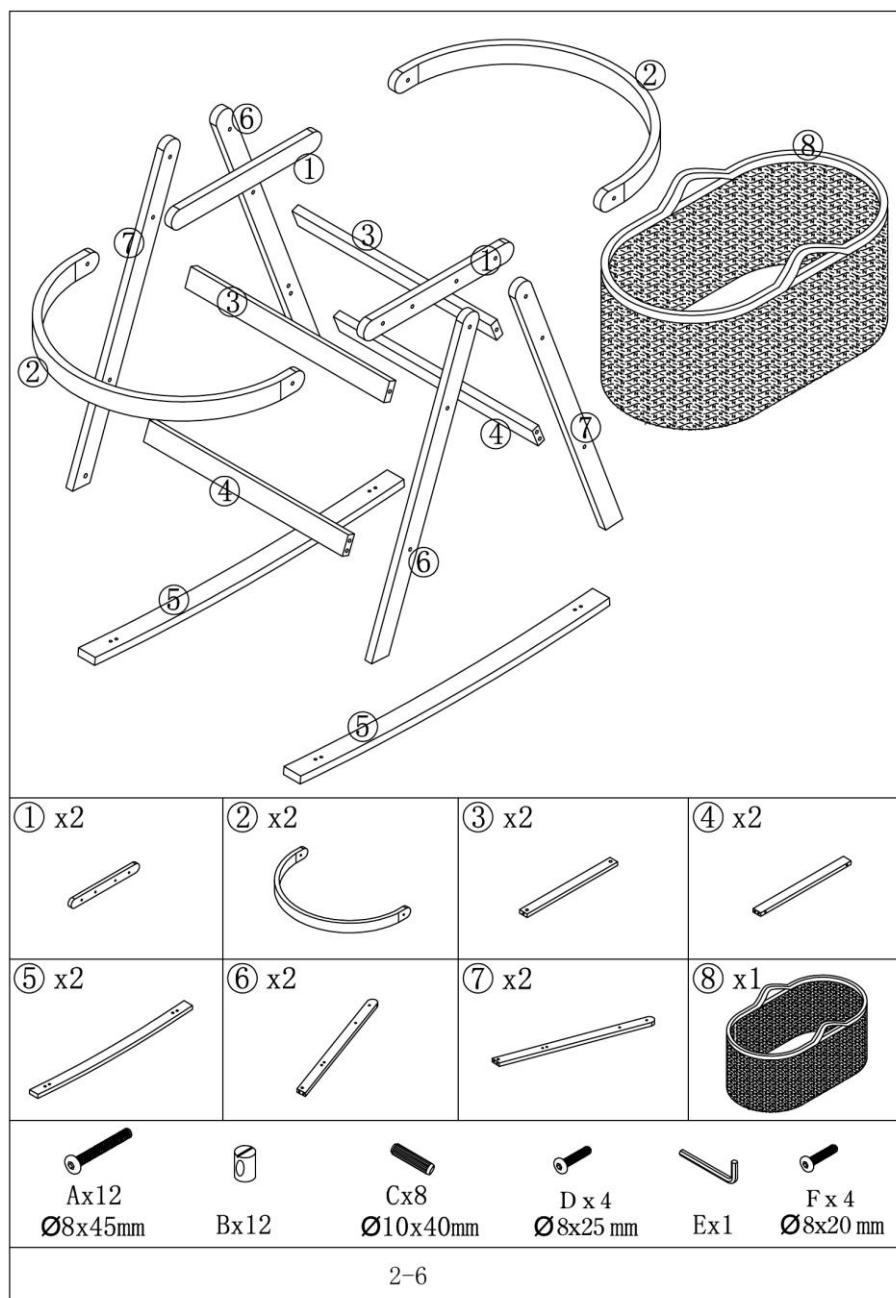

Bankverbindung CHF:
IBAN: CH06 0021 0210 1087 0101 V
BIC / SWIFT: UBSWCHZH80A

Bankverbindung EUR:
IBAN: CH23 0021 0210 1087 0160 X
BIC / SWIFT: UBSWCHZH80A

Kontakt
LIINI GmbH
Bahnhofstrasse 21
4571 Lüterkofen
Web: www.LIINI.ch
E-Mail: info@LIINI.ch
Tel: +41 79 559 06 02

Rechtliches
UID: CHE-131.522.878 MWST
Steuernr. DE: 09417/18455
Umsatzsteuer-ID: DE352084049
EORI-Nr: DE905090565529397
Zollkonto ZAZ: 19867-7



#Feels Parenting.

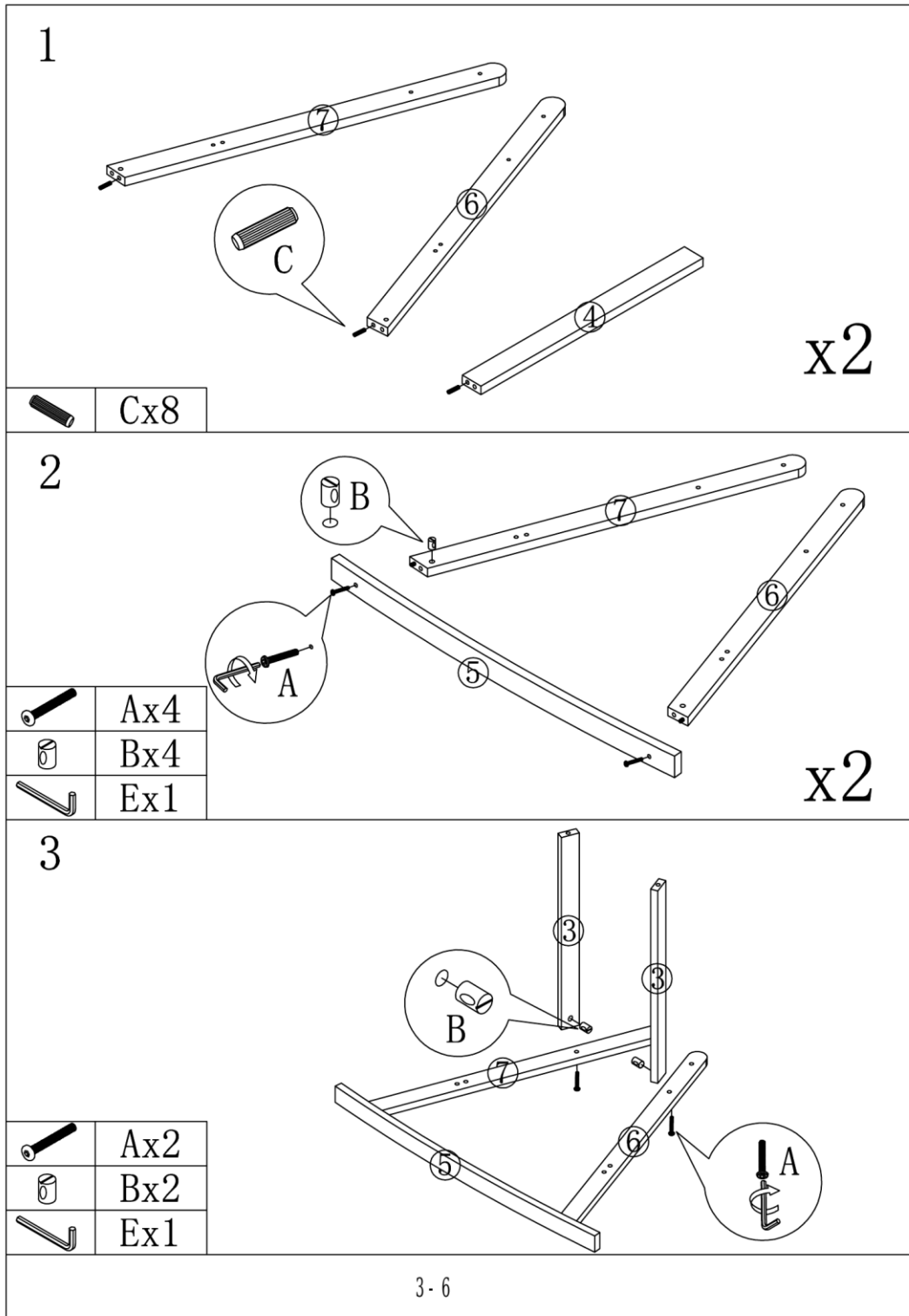

Bankverbindung CHF:
IBAN: CH06 0021 0210 1087 0101 V
BIC / SWIFT: UBSWCHZH80A

Bankverbindung EUR:
IBAN: CH23 0021 0210 1087 0160 X
BIC / SWIFT: UBSWCHZH80A

Kontakt
LIINI GmbH
Bahnhofstrasse 21
4571 Lüterkofen
Web: www.LIINI.ch
E-Mail: info@LIINI.ch
Tel: +41 79 559 06 02

Rechtliches
UID: CHE-131.522.878 MWST
Steuernr. DE: 09417/18455
Umsatzsteuer-ID: DE352084049
EORI-Nr: DE905090565529397
Zollkonto ZAZ: 19867-7



#Feels Parenting.

4

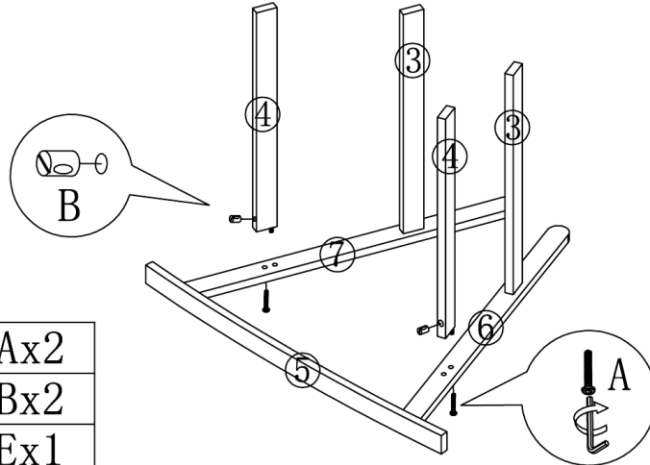

	Ax2
	Bx2
	Ex1

5

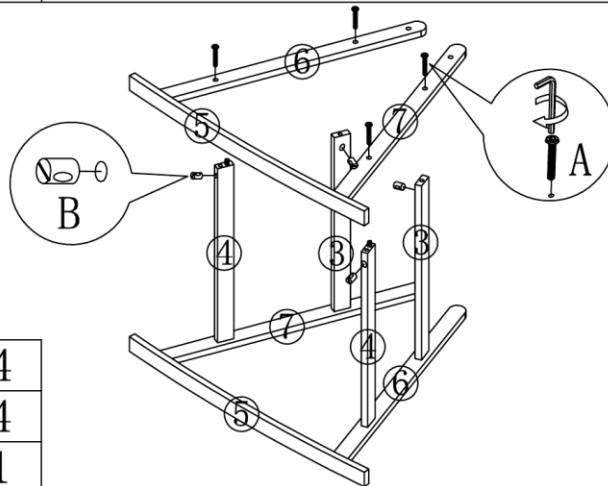

	Ax4
	Bx4
	Ex1

6

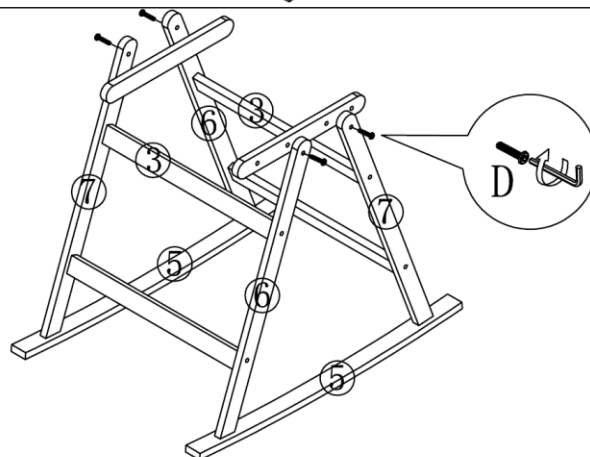

	Dx4
	Ex1

4 - 6

Bankverbindung CHF:
IBAN: CH06 0021 0210 1087 0101 V
BIC / SWIFT: UBSWCHZH80A

Bankverbindung EUR:
IBAN: CH23 0021 0210 1087 0160 X
BIC / SWIFT: UBSWCHZH80A

Kontakt
LIINI GmbH
Bahnhofstrasse 21
4571 Lütetkofen
Web: www.LIINI.ch
E-Mail: info@LIINI.ch
Tel: +41 79 559 06 02

Rechtliches
UID: CHE-131.522.878 MWST
Steuernr. DE: 09417/18455
Umsatzsteuer-ID: DE352084049
EORI-Nr: DE905090565529397
Zollkonto ZAZ: 19867-7



#Feels Parenting.

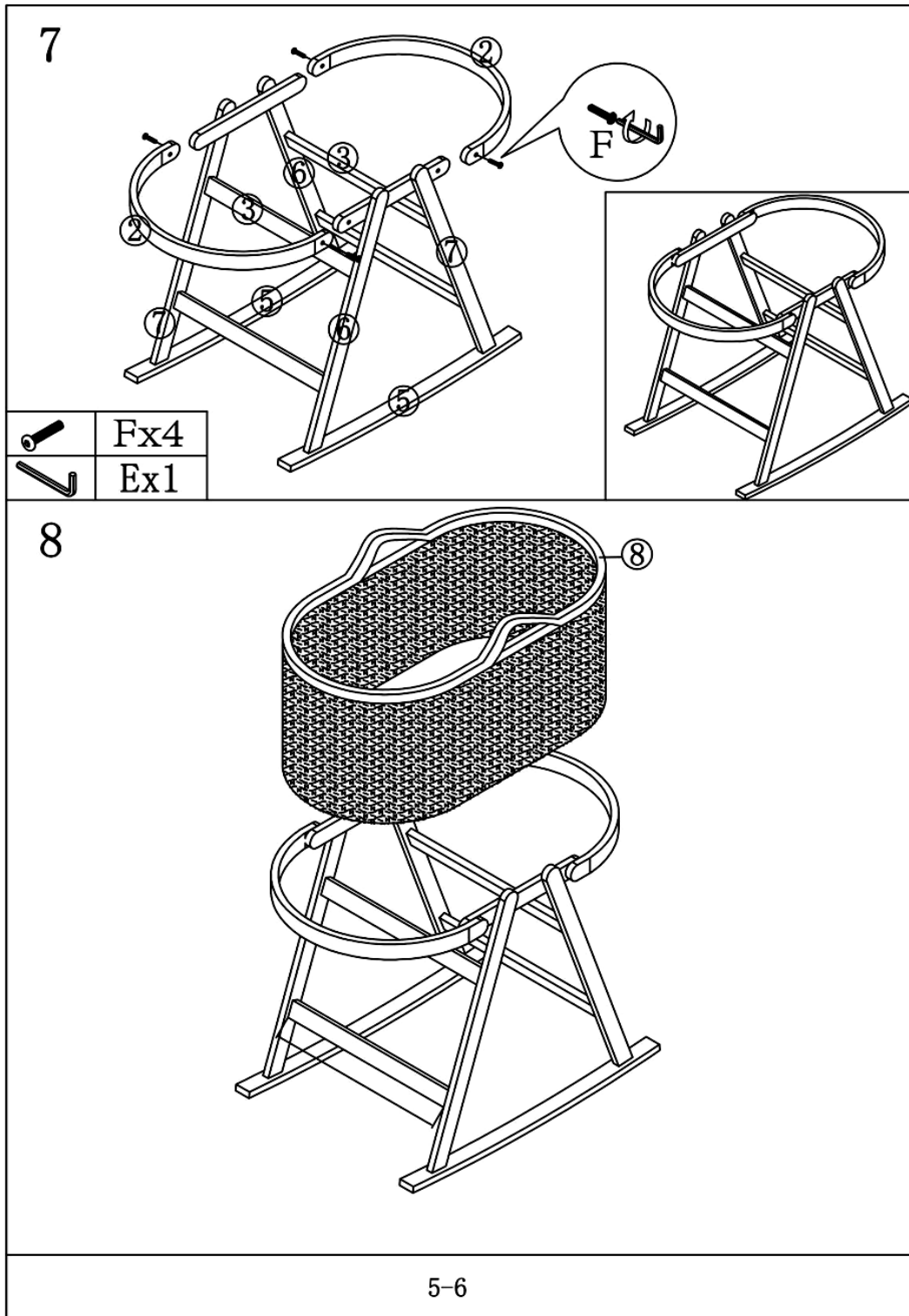

Bankverbindung CHF:
IBAN: CH06 0021 0210 1087 0101 V
BIC / SWIFT: UBSWCHZH80A

Bankverbindung EUR:
IBAN: CH23 0021 0210 1087 0160 X
BIC / SWIFT: UBSWCHZH80A

Kontakt
LIINI GmbH
Bahnhofstrasse 21
4571 Lüterkofen
Web: www.LIINI.ch
E-Mail: info@LIINI.ch
Tel: +41 79 559 06 02

Rechtliches
UID: CHE-131.522.878 MWST
Steuernr. DE: 09417/18455
Umsatzsteuer-ID: DE352084049
EORI-Nr: DE905090565529397
Zollkonto ZAZ: 19867-7



#Feels Parenting.

Care instructions – washing symbols according to GINETEX



The mattress cover of the baby cradle is removable and can be cleaned according to the GINETEX care symbols. These internationally standardised symbols are binding, even if they are not always self-explanatory.

The mattress cover can be washed at 30°C on a gentle cycle. A gentle drying process at a maximum of 60°C is suitable for drying. The cover must not be ironed or bleached, as this can damage the material and impair the function of the cover.

Please follow these care instructions carefully to ensure the hygiene, dimensional stability and longevity of the mattress cover.

Bankverbindung CHF:
IBAN: CH06 0021 0210 1087 0101 V
BIC / SWIFT: UBSWCHZH80A

Bankverbindung EUR:
IBAN: CH23 0021 0210 1087 0160 X
BIC / SWIFT: UBSWCHZH80A

Kontakt
LIINI GmbH
Bahnhofstrasse 21
4571 Lüterkofen
Web: www.LIINI.ch
E-Mail: info@LIINI.ch
Tel: +41 79 559 06 02

Rechtliches
UID: CHE-131.522.878 MWST
Steuernr. DE: 09417/18455
Umsatzsteuer-ID: DE352084049
EORI-Nr: DE905090565529397
Zollkonto ZAZ: 19867-7